

60 James Lane, London, E10 6HL
£1,700 Per Month



60 James Lane, London, E10 6HL

£1,700 Per Month

Council Tax Band: B

Welcome to this charming one-bedroom flat located in the vibrant area of Leytonstone, E11, available to let at £1,700 per calendar month. This modern ground floor flat offers a comfortable and stylish living space, perfect for individuals or couples seeking a convenient urban lifestyle.

Upon entering, you will find a well-proportioned reception room that provides a welcoming atmosphere, ideal for relaxation or entertaining guests. The flat features a spacious bedroom, designed to be a peaceful retreat, ensuring a restful night's sleep. The contemporary bathroom is fitted with modern fixtures, providing both functionality and comfort.

The property benefits from its prime location, with excellent transport links nearby, making it easy to explore the wider London area. Leytonstone is known for its diverse community, offering a variety of shops, cafes, and restaurants, all within walking distance. The nearby parks provide a lovely escape for outdoor









337 Forest Road
London
E17 5JR
02085277007

enquiries@completion.co.uk
completion.co.uk

Ground Floor
Approx. 58.0 sq. metres (624.5 sq. feet)

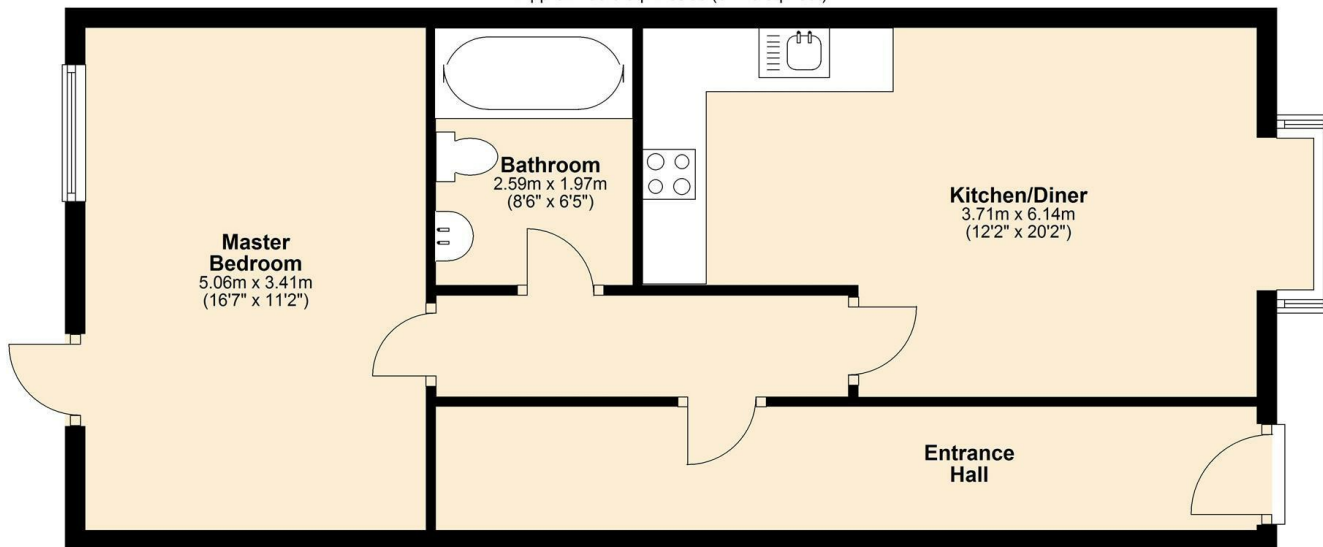

Energy Efficiency Rating		
	Current	Potential
Very energy efficient - lower running costs		
(92 plus) A		
(81-91) B		
(69-80) C	78	82
(55-68) D		
(39-54) E		
(21-38) F		
(1-20) G		
Not energy efficient - higher running costs		
England & Wales	EU Directive 2002/91/EC	